

REV	REVISION DETAILS	ECO	DATE	BY	ABY
0	RELEASE FOR PRODUCTION	N/A	08-09-2017	RRR	JML
1	UPDATE DIMENSION TO REF. AND CORRECT	NP-2286	01-23-2020	JJW	JML
2	UPDATE FORMAT, ADDITION OF -2 SEAL SC14-2008A-B015, CORRECT REF TABLE A I2077413 TO 3mm2, ADD COLOR TO SEAL DESCRIPTION SHEET 3, COVERS WITH TETHERS TO OBSOLETE, TOP MOUNT 6mm TO OBSOLETE, CLARIFIED TERMINALS NOTES 3, 4, TABLE A AND TABLE B, ADDED M6 TO PDM-TMC, ADDED PDM-UXFXXX TERMINAL NUMBER VIEW AND CLARIFIED QTY IN PDM-UT1 AND PDM-UT5 NOTES	NP-003712	05-27-2021	JJW	JML
3	PART NUMBER WAS PDM-UXXXX. UPDATED DESCRIPTION. UPDATED TO CURRENT DRAWING STANDARDS.	NP-003761	01-15-2024	JWK	JML

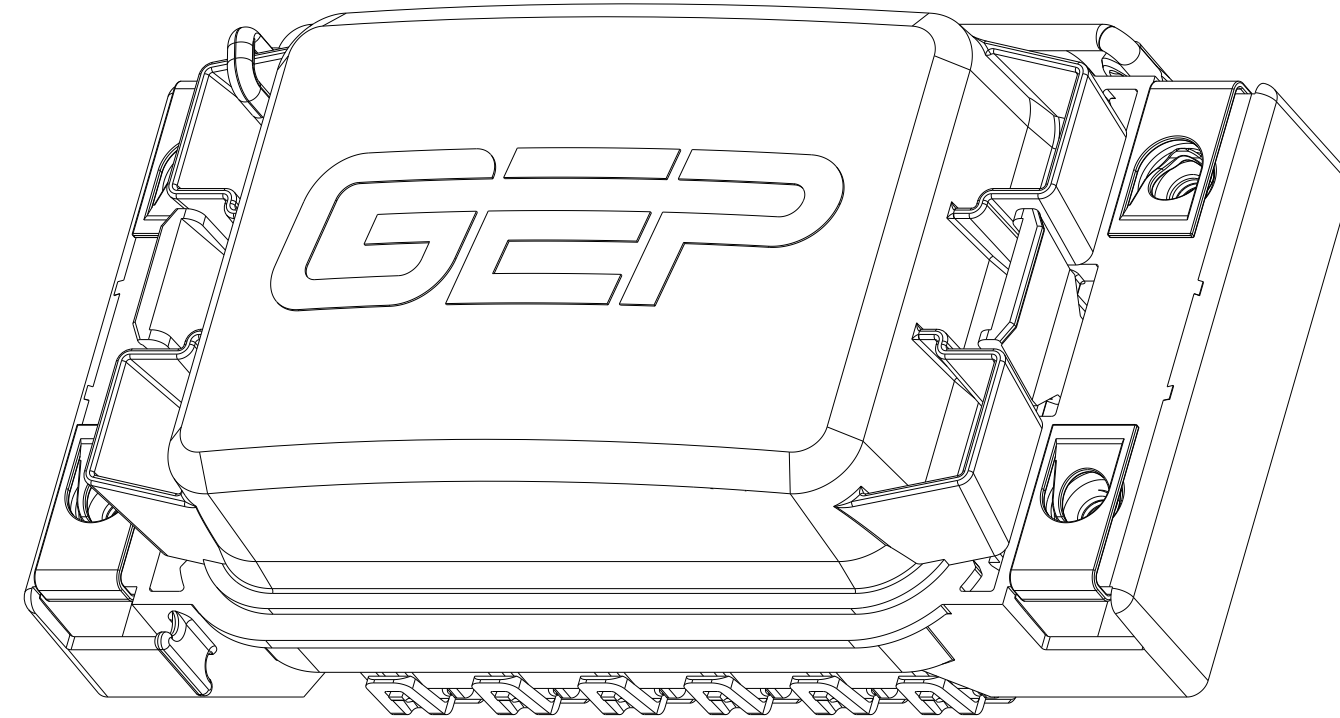

ISO VIEW
FOR REF ONLY

CONFIDENTIAL

The information contained in this document is the property of GEP Power Products. It is not for public disclosure. Possession of the information does not convey any right to loan, sell or disclose the information. Unauthorized reproduction or use of the information is prohibited. This document is to be returned to GEP Power Products upon completion of the purpose for which it is loaned or upon request.

CRITICAL DIMENSIONS ON FEATURES TO BE CHECKED DURING ANY SET-UP ADJUSTMENTS, TOOL CHANGES, OR ANNUAL MAINTENANCE ON TOOLING.

DIMENSIONS OR FEATURES TO BE CHECKED FROM RUN-TO-RUN

TOLERANCES UNLESS OTHERWISE SPECIFIED

THIRD ANGLE PROJECTION

METRIC TOL

ENGLISH TOL

ANGULAR TOL = $\pm 2^\circ$
FRACTION TOL = $\pm 1/64$ IN

1 PL DEC. = $\pm .25$
2 PL DEC. = $\pm .13$

2 PL DEC. = $\pm .01$
3 PL DEC. = $\pm .005$

DIMENSIONS INSIDE PARENTHESES OR CONTAINING "REF" ARE FOR REFERENCE ONLY.

COPYRIGHT - GEP POWER PRODUCTS

This is unpublished work. The disclosure of this work is limited to a select personnel. Further dissemination or disclosure to the public is PROHIBITED. This unpublished work is protected by Federal Copyright law and all rights thereunder are reserved by GEP Power Products.

		16830 Pheasant Drive Brookfield, WI 53005		
PART NO:		PDM-U SERIES (SALES)		
DESCRIPTION:		POWER DISTRIBUTION MODULE - MODEL U, SERIES DRAWING		
CUSTOMER:		STANDARD		
METRIC (MM)	REV	SHEET	SCALE	SIZE
	3	1 OF 9	1:1	B

EXAMPLE CONFIGURATION & NOTES

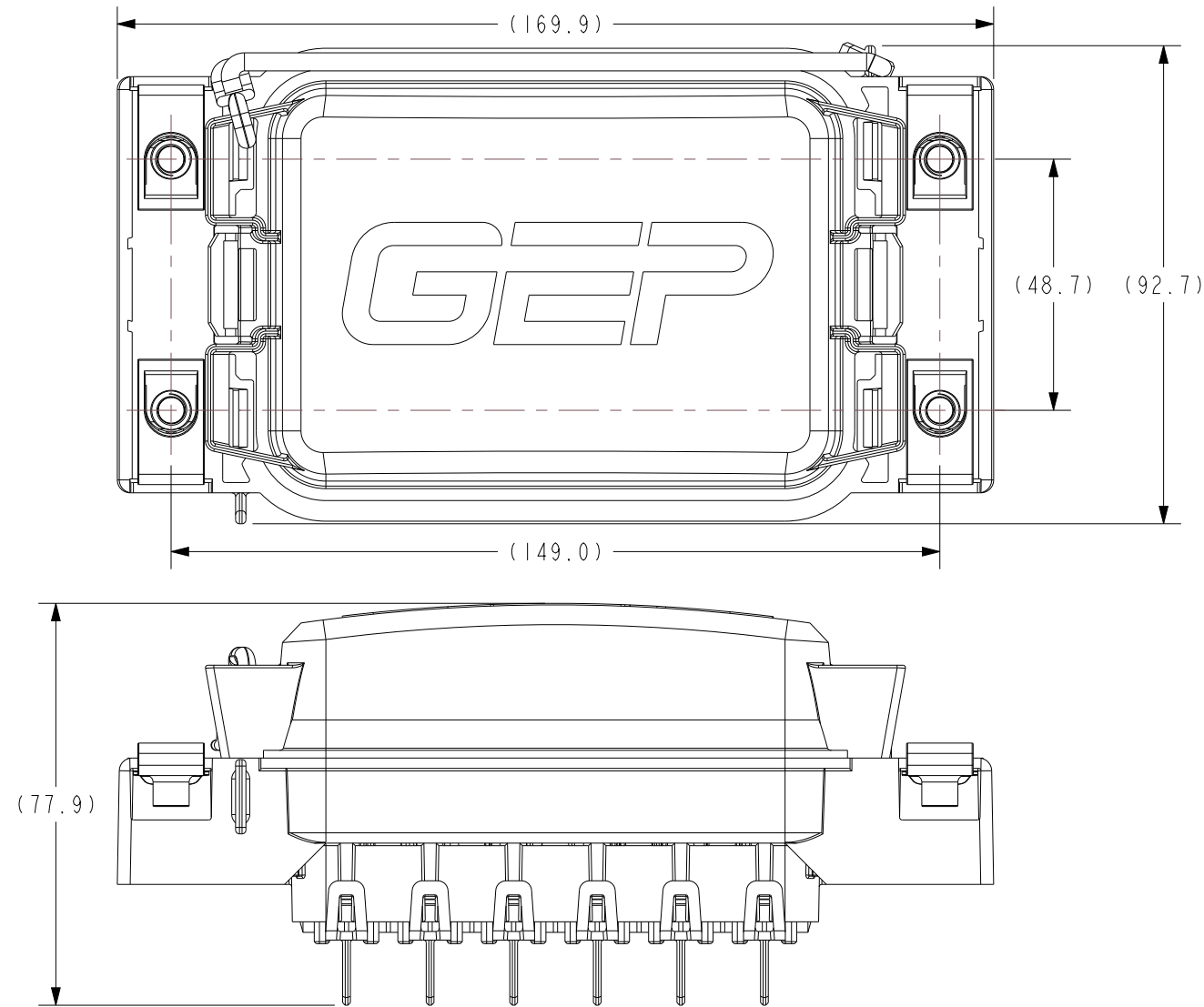

EXAMPLE CONFIGURATION WITH DIMENSIONAL INFO

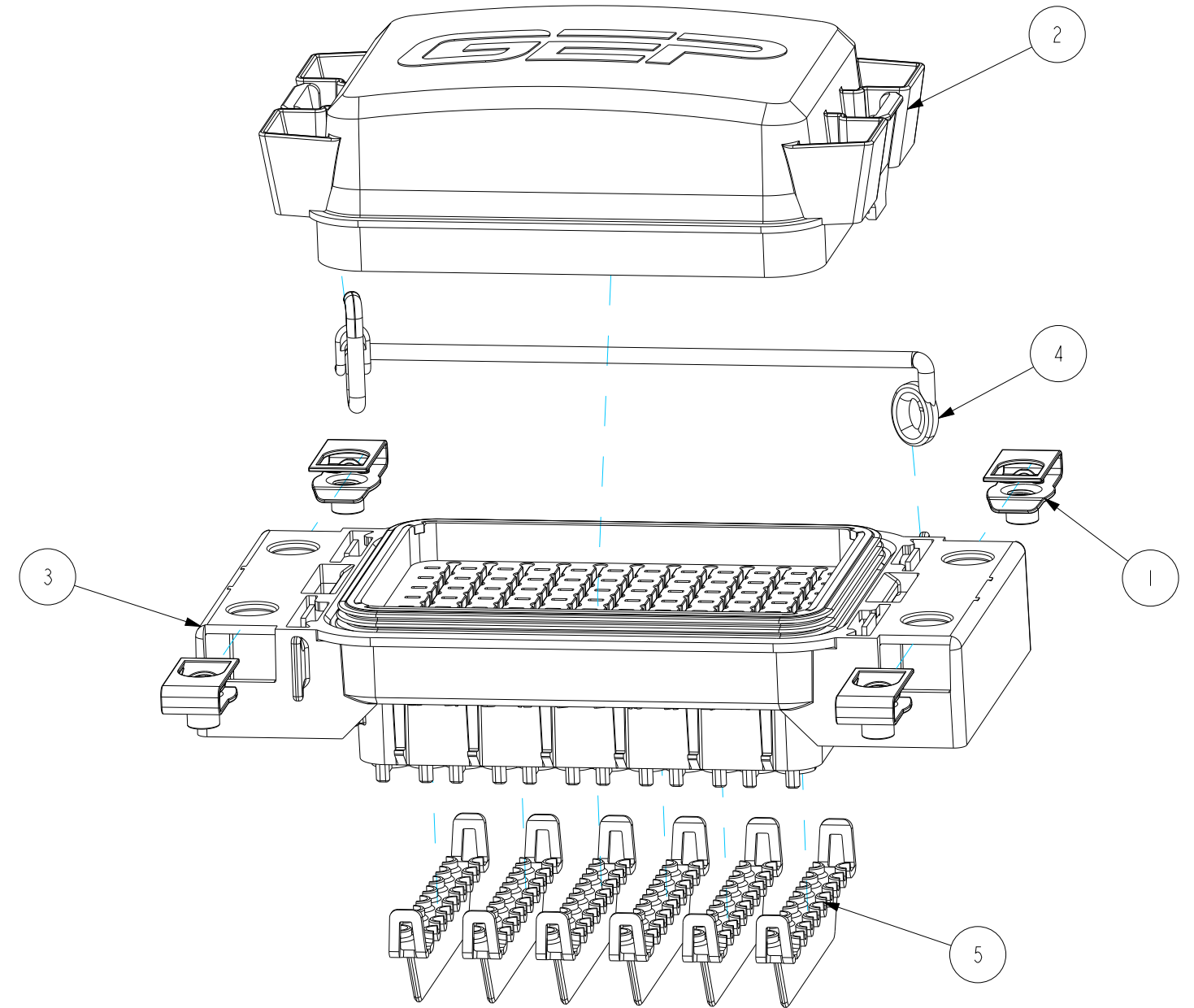

EXAMPLE CONFIGURATION EXPLODE VIEW

NOTES:

1. BLOCK & COVER MATERIAL: PBT POLYESTER
2. BLOCK & COVER FINISH/COLOR: MATTE/BLACK
3. SEAL COLOR: BLUE
4. SC42-2008A-B001 TERMINALS AND SEALS
280 CAVITIES
TERMINALS: DELPHI METRI-PACK 280 SERIES TERMINALS, SEE TABLE A, SHEET 6
SEALS: DELPHI METRI-PACK 280 SERIES SEALS, SEE TABLE A, SHEET 6
5. SC42-2008B-B001 TERMINALS AND SEALS
280 CAVITIES
TERMINALS: DELPHI METRI-PACK 280 SERIES TERMINALS, SEE TABLE A, SHEET 6
SEALS: DELPHI METRI-PACK 280 SERIES SEALS, SEE TABLE A, SHEET 6
630 CAVITIES
TERMINALS: DELPHI METRIC-PACK 630 SERIES TERMINALS, SEE TABLE B, SHEET 6
SEALS: DELPHI METRI-PACK 480 SERIES SEALS, SEE TABLE B, SHEET 6
6. CORRECT TERMINAL SEALS AND/OR CAVITY PLUGS MUST BE USED TO INSURE A SEALED UNIT
7. RECOMMENDED MAXIMUM MOUNTING TORQUE: 40 IN-LBS
8. DIMENSIONS ARE FOR REFERENCE ONLY
9. TABLES A AND B: AVAILABILITY OF INDIVIDUAL PART NUMBERS NEEDS TO BE VERIFIED WITH THE TERMINAL MANUFACTURER
10. RoHS AND REACH COMPLIANT

EXAMPLE ASSEMBLY BOM			
ITEM	DESCRIPTION	PART NO.	QTY
1	CLIP - M6 - 1 U-SPRING NUT	PDM-TMC	4
2	COVER - PDM-U, GEP	PDM-UC	1
3	HOUSING AND SEAL - PDM-U, 96 POS, 280 TERM, 10MM	SC42-2008A-B001	1
4	TETHER - COVER	PDM-SCT	1
5	TPA - 280 TERMINALS	PDM-UT1	6

GEP POWER PRODUCTS 16830 Pheasant Drive Brookfield, WI 53005

PART NO: PDM-U SERIES (SALES)

DESCRIPTION: POWER DISTRIBUTION MODULE - MODEL U, SERIES DRAWING

CUSTOMER: STANDARD

METRIC (MM)	REV 3	SHEET 2 OF 9	SCALE 1:1.333	SIZE B
-------------	-------	--------------	---------------	--------

HOUSING W/SEAL OPTIONS

SC42-2008A-B001
 HOUSING AND SEAL - PDM-U, 96 POS, 280 TERM, 10MM
 SEE NOTE 4

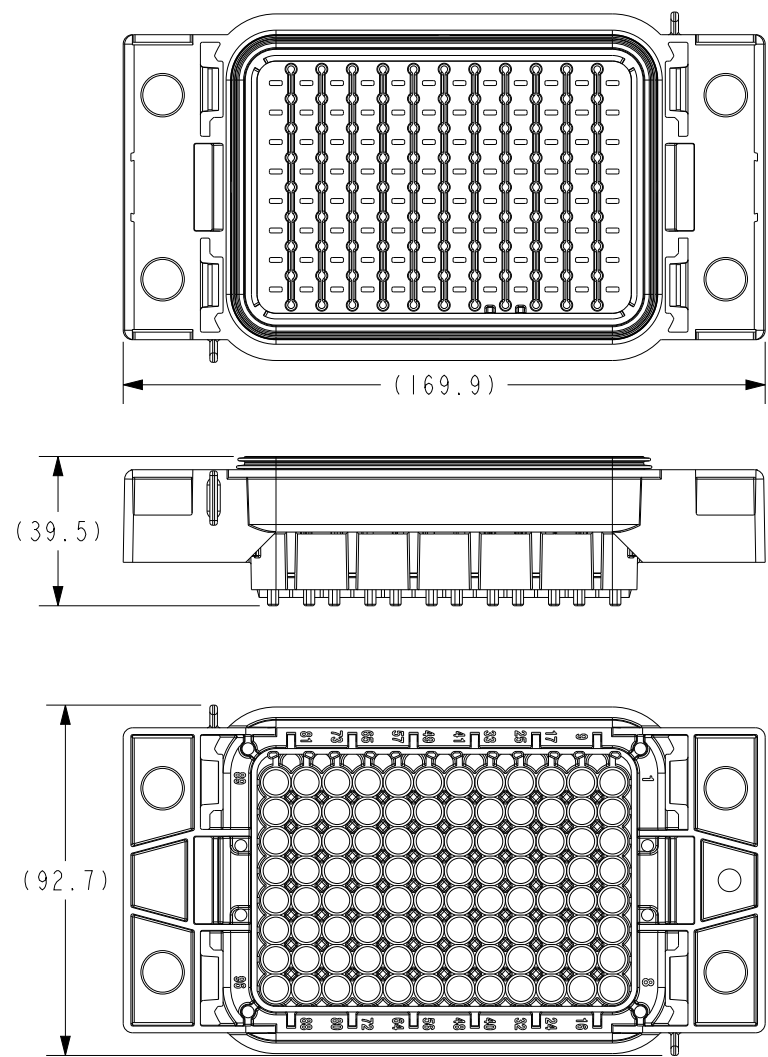

SC42-2008B-B001
 HOUSING AND SEAL - PDM-U, 92 POS, 280 AND ATO TERM, 10MM
 SEE NOTE 5

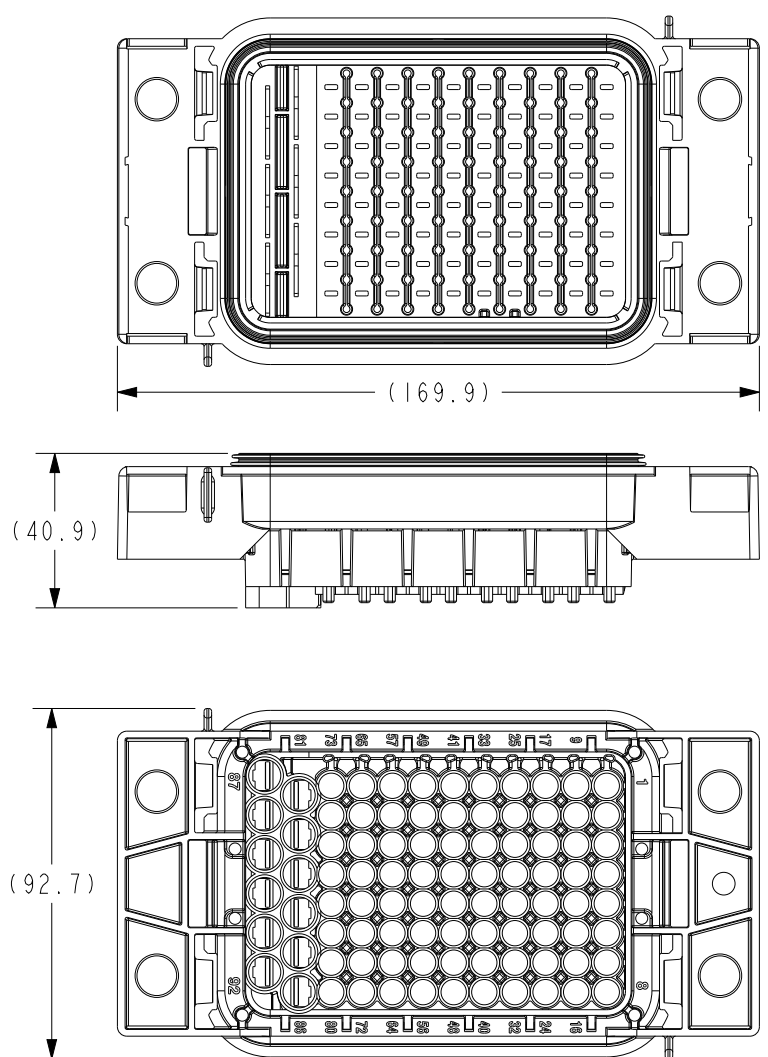

		16830 Pheasant Drive Brookfield, WI 53005		
PART NO:		PDM-U SERIES (SALES)		
DESCRIPTION:		POWER DISTRIBUTION MODULE - MODEL U, SERIES DRAWING		
CUSTOMER:		STANDARD		
METRIC (MM)	REV	SHEET	SCALE	SIZE
	3	3 OF 9	1:2	B

COVER OPTIONS

PDM-UCP
COVER - PDM-U, PLAIN

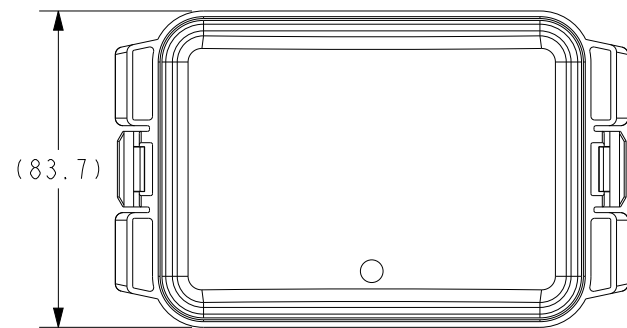
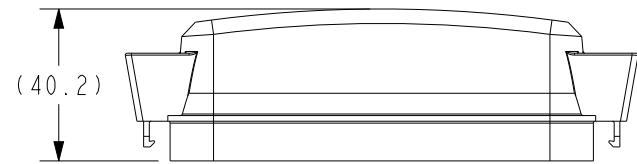
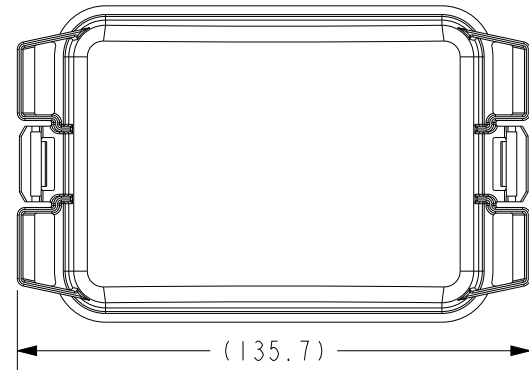

PDM-UC
COVER - PDM-U, GEP

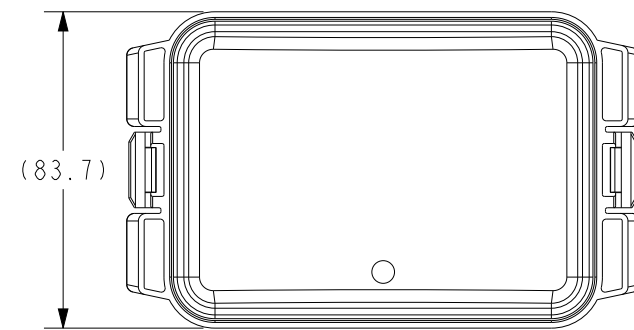
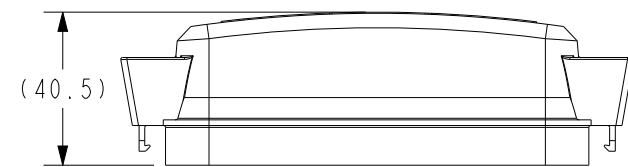
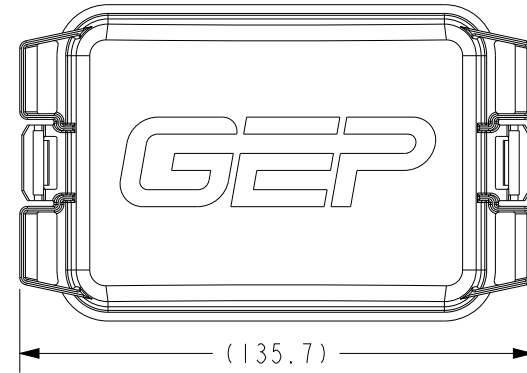

		16830 Pheasant Drive Brookfield, WI 53005		
PART NO:		PDM-U SERIES (SALES)		
DESCRIPTION:		POWER DISTRIBUTION MODULE - MODEL U, SERIES DRAWING		
CUSTOMER:		STANDARD		
METRIC (MM)	REV	SHEET	SCALE	SIZE
	3	4 OF 9	1:1	B

ACCESSORIES

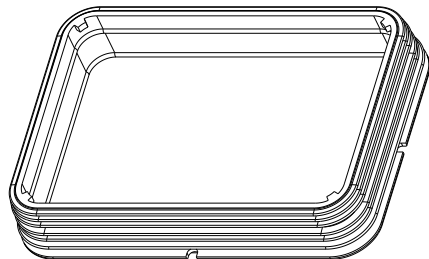

SC14-2008A-B015
COVER SEAL BLUE
(ENHANCED SEALING AND UL94 V0)
(INCLUDED WITH SC42-2008A-B001
AND SC42-2008B-B001)

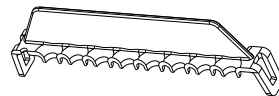

PDM-UT1
280 TPA
(6 PER ASSY REQUIRED FOR SC42-2008A-B001)
(5 PER ASSY REQUIRED FOR SC42-2008B-B001)

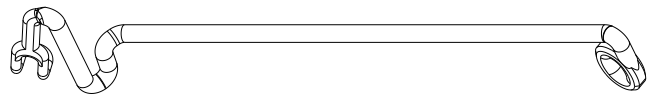

PDM-SCT
COVER TETHER

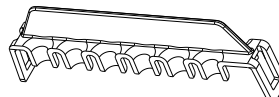

PDM-UT5
630 TPA
(1 PER ASSY REQUIRED FOR SC42-2008B-B001)



SCALE 2:1

PDM-TK
DIODE KEY

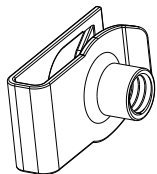

SCALE 1:1

PDM-TMC
MOUNTING CLIP M6

		16830 Pheasant Drive Brookfield, WI 53005		
PART NO:		PDM-U SERIES (SALES)		
DESCRIPTION:		POWER DISTRIBUTION MODULE - MODEL U, SERIES DRAWING		
CUSTOMER:		STANDARD		
METRIC (MM)	REV	SHEET	SCALE	SIZE
	3	5 OF 9	1:1.5	B

TERMINALS AND SEALS

TABLE A

TERMINALS / SEALS (REF. ONLY)				
DELPHI 280 METRI-PACK TERMINALS				
PART #	CABLE RANGE (MM2)	MATERIAL	PLATING	
12077413	3.0	TIN BRASS	TIN	
12129493	2.0-3.0	TIN BRASS	TIN	
12077411	0.8-1.0	TIN BRASS	TIN	
12084201	0.35-0.50	TIN BRASS	TIN	
12176387	5.0	BERYLLIUM COPPER	SILVER/NICKEL	
12176388	2.0-3.0	BERYLLIUM COPPER	SILVER/NICKEL	
12176389	0.8-1.0	BERYLLIUM COPPER	SILVER/NICKEL	
DELPHI 280 METRI-PACK CABLE SEALS (REF. ONLY)				
PART # REEL	PART # LOOSE	CABLE DIAMETER	MATERIAL	COLOR
12015360	12015193	3.45-4.3	SILICONE	BLUE
12015359	12010293	2.81-3.49	SILICONE	LT. GRAY
12015284	12015323	2.03-2.85	SILICONE	GREEN
12041352	12041351	2.03-2.42	SILICONE	TAN
12089444	12089679	1.6-2.15	SILICONE	PURPLE
12034365	12015899	1.29-1.70	SILICONE	DK. RED
	12010300	PLUG	SILICONE	GREEN
DELPHI METRI-PACK TERMINAL REMOVAL TOOL (FOR REF. ONLY)				
PART # 12094430				

TABLE B

DELPHI 630 METRI-PACK TERMINALS (REF. ONLY)				
PART #	RANGE (MM2)	MATERIAL	PLATING	
15317331	4.00-6.00	TIN BRASS	TIN	
12052456	3.00-5.00	TIN BRASS	TIN	
12052455	1.00-2.00	TIN BRASS	TIN	
12052457	0.50-0.80	TIN BRASS	TIN	
15317332	4.00-6.00	BERYLLIUM COPPER	SILVER/NICKEL	
15305232	3.00-5.00	BERYLLIUM COPPER	SILVER/NICKEL	
DELPHI 480 METRI-PACK CABLE SEALS - SEE NOTE BELOW (REF. ONLY)				
PART # REEL	PART # LOOSE	CABLE DIAMETER	MATERIAL	COLOR
15344644	15363779	1.20-2.00	SILICONE	YELLOW
12052931	12052930	1.60-2.15	SILICONE	YELLOW
	15327998	2.00-2.70	SILICONE	BLUE
12048433	12048441	2.00-2.90	SILICONE	WHITE
15344645	15363604	2.00-2.90	SILICONE	WHITE
12052452	12048442	2.80-3.90	SILICONE	DK. RED
15337204	15327864	2.80-3.80	SILICONE	DK. RED
15344646	15363605	3.60-4.50	SILICONE	GREEN
10733034	10733145	4.40-5.10	SILICONE	GRAY
15344104	15344647	4.40-5.10	SILICONE	GRAY
	12066082	PLUG	SILICONE	LT. GREEN
DELPHI METRI-PACK TERMINAL REMOVAL TOOL (FOR REF. ONLY)				
PART # 12094430				

NOTE: 630 CAVITIES USING TERMINALS IN TABLE B ARE DESIGNED TO BE USED WITH 480 SERIES CABLE SEALS

		16830 Pheasant Drive Brookfield, WI 53005		
		PART NO: PDM-U SERIES (SALES)		
DESCRIPTION: POWER DISTRIBUTION MODULE - MODEL U, SERIES DRAWING				
CUSTOMER: STANDARD				
METRIC (MM)	REV	SHEET	SCALE	SIZE
	3	6 OF 9	1:1.5	B

MOUNTING OPTIONS

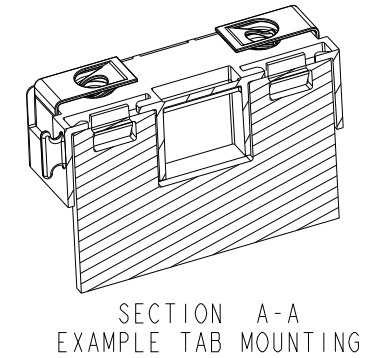
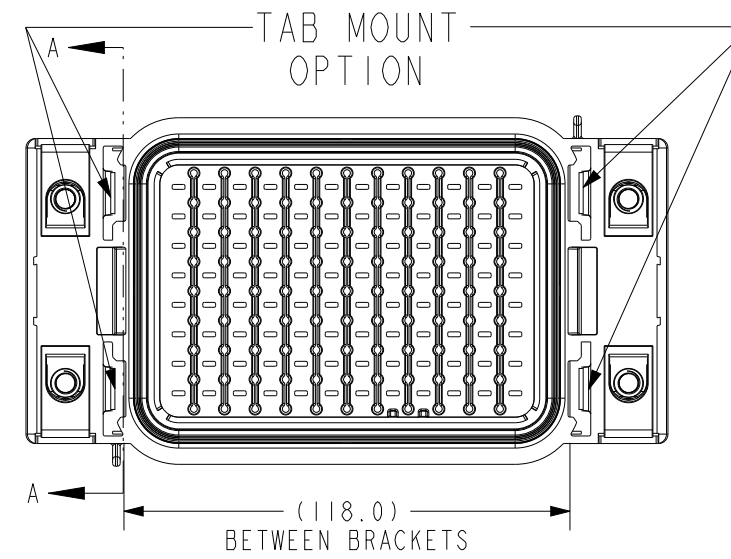
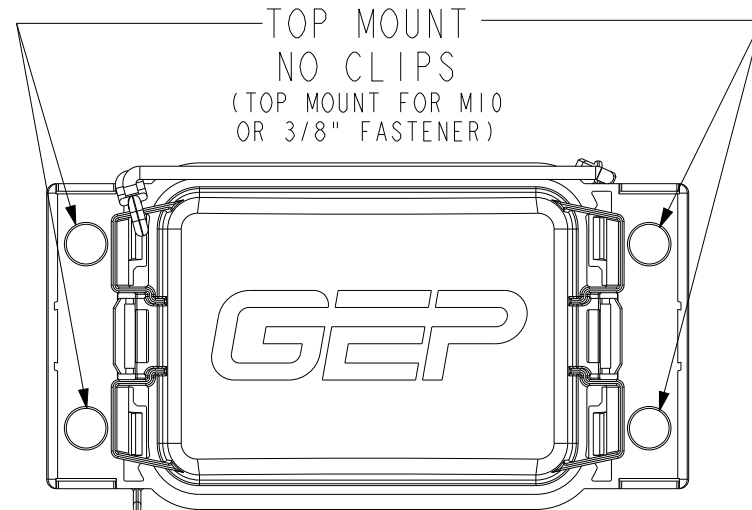
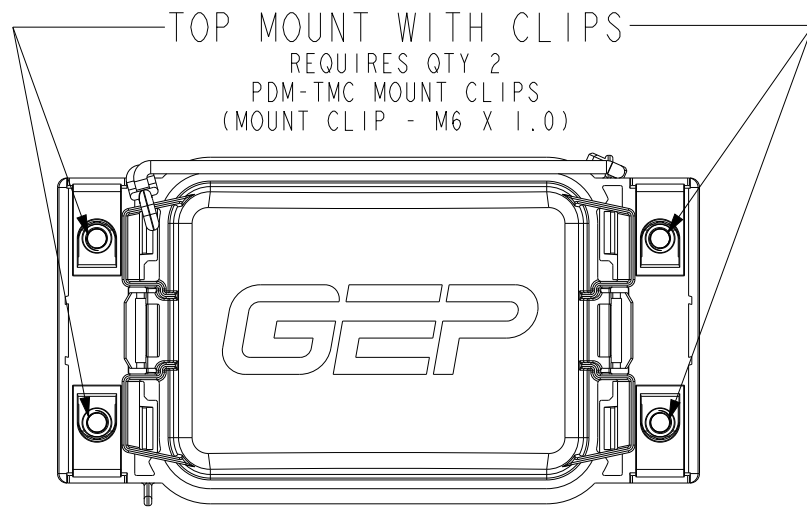

PANEL CUTOUT (NO TETHER)

PANEL CUTOUT (TETHER)

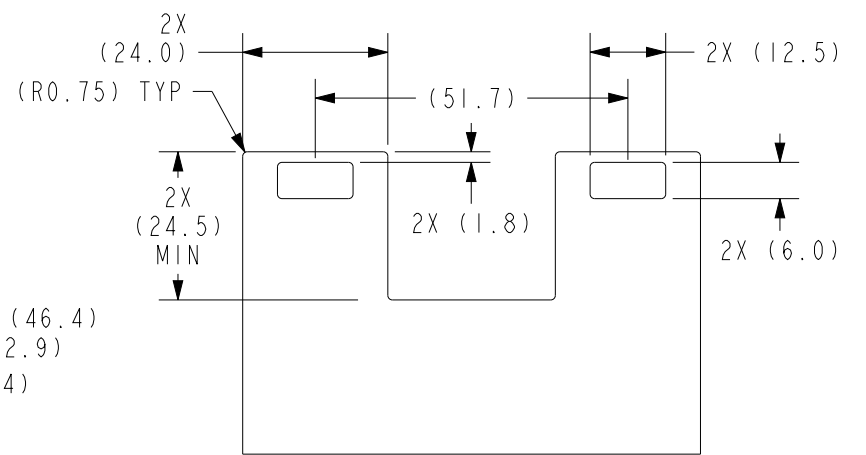
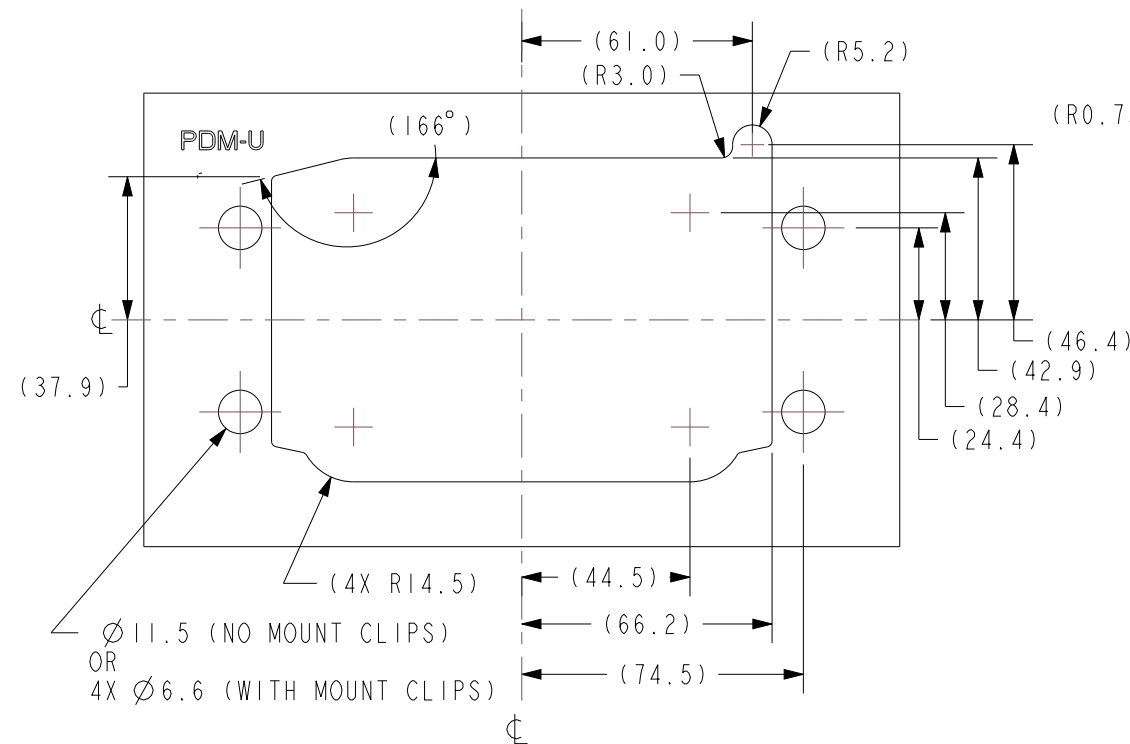
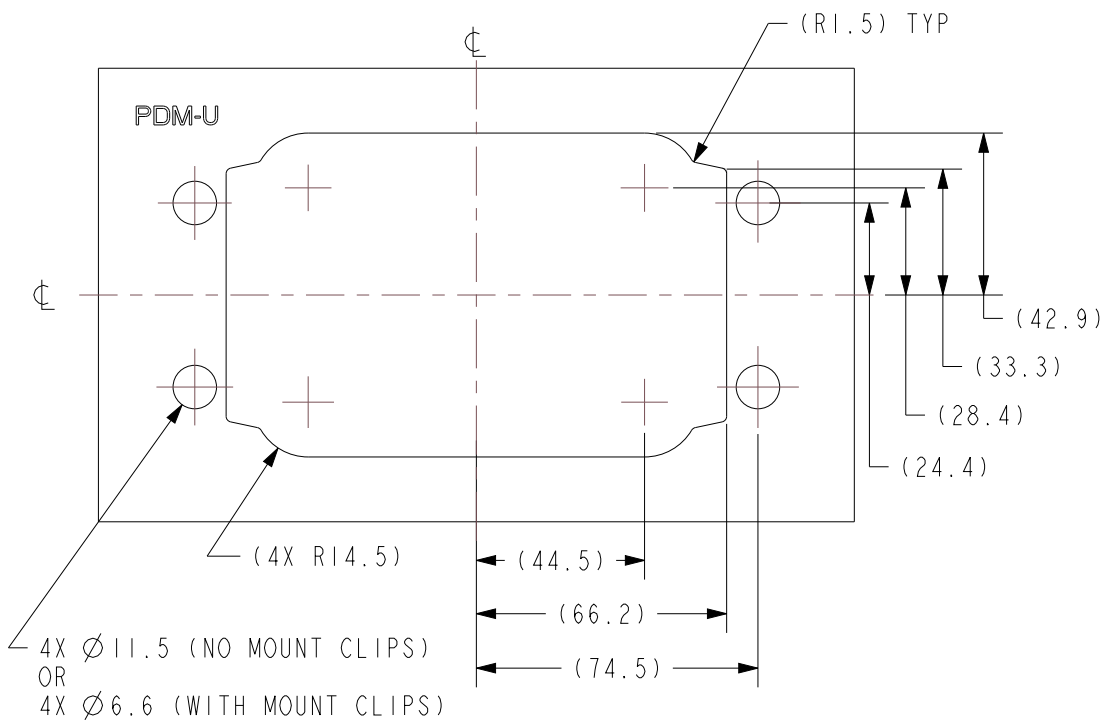

SCALE 1:1.25

MOUNT BRACKET

RECOMMENDED THICKNESS: 2 TO 3.2MM
(CUSTOMER SUPPLIED)

		16830 Pheasant Drive Brookfield, WI 53005		
PART NO:		PDM-U SERIES (SALES)		
DESCRIPTION:		POWER DISTRIBUTION MODULE - MODEL U, SERIES DRAWING		
CUSTOMER:		STANDARD		
METRIC (MM)	REV	SHEET	SCALE	SIZE
	3	7 OF 9	1:2	B

ASSEMBLY INSTRUCTIONS

MOUNTING CLIP INSTALLATION

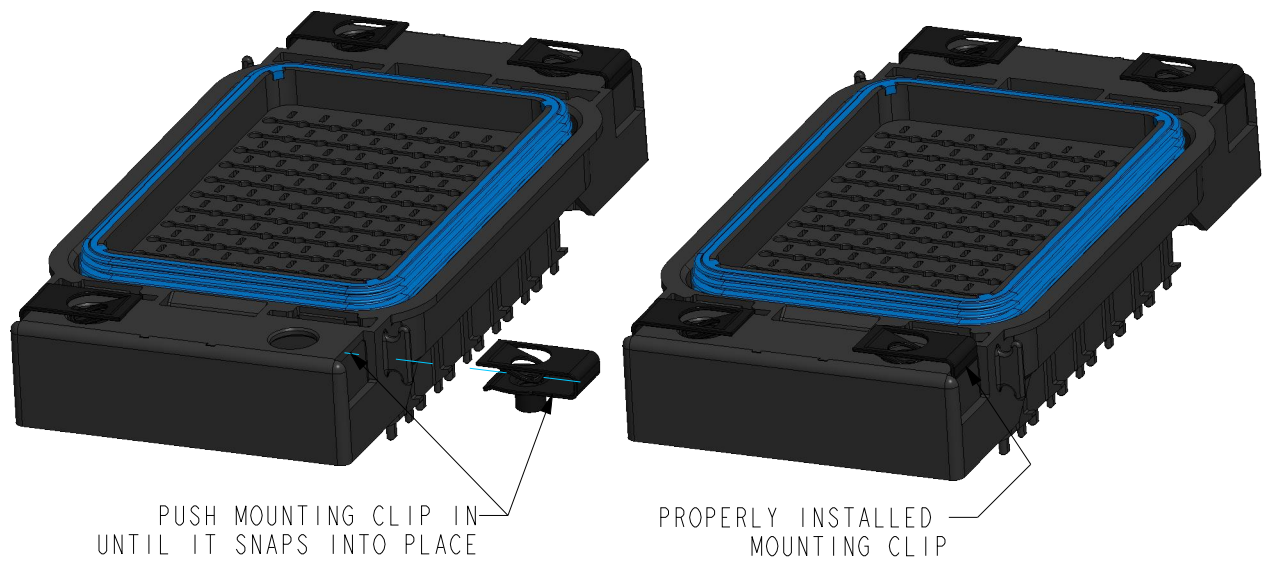

SEAL INSTALLATION

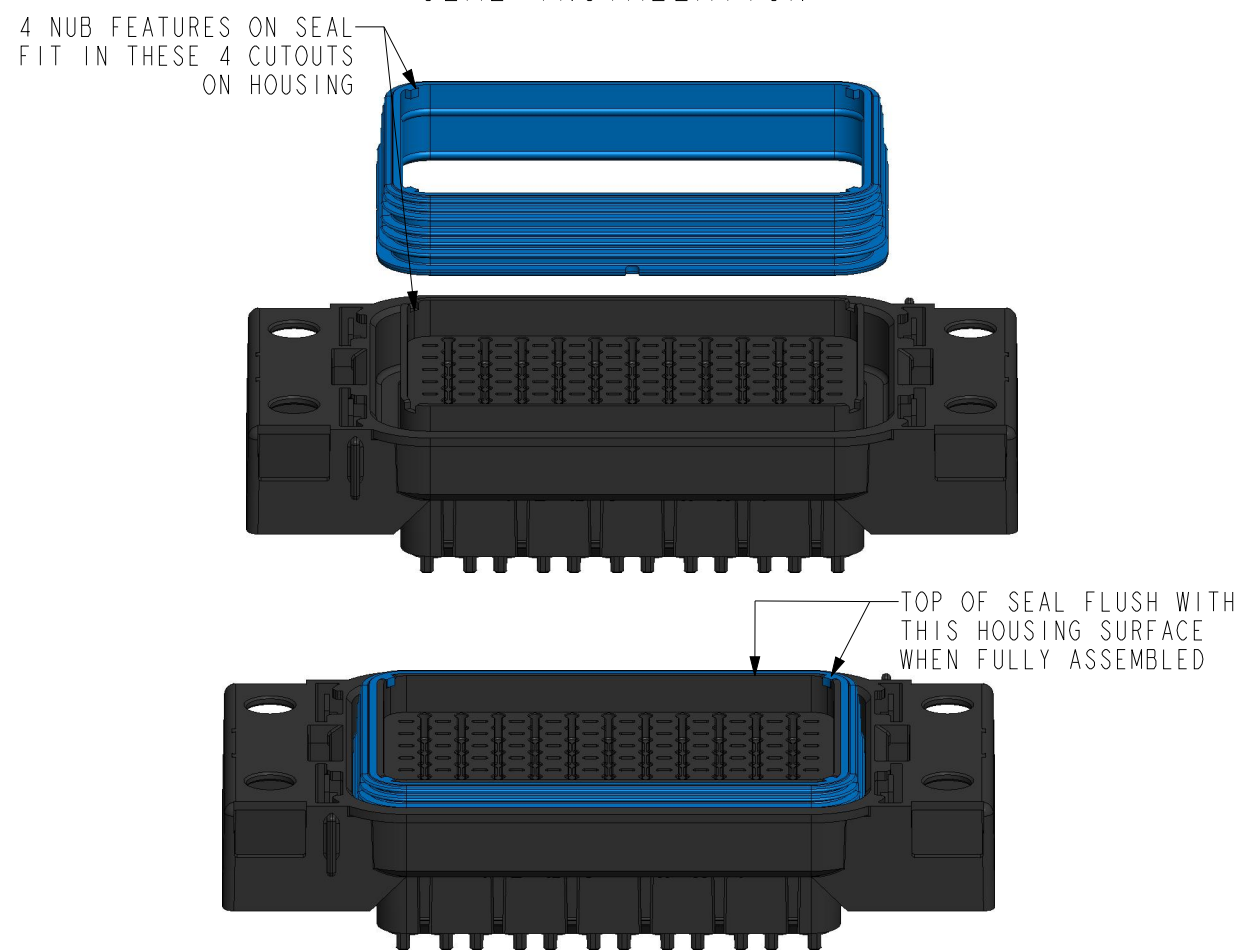

TETHER INSTALLATION

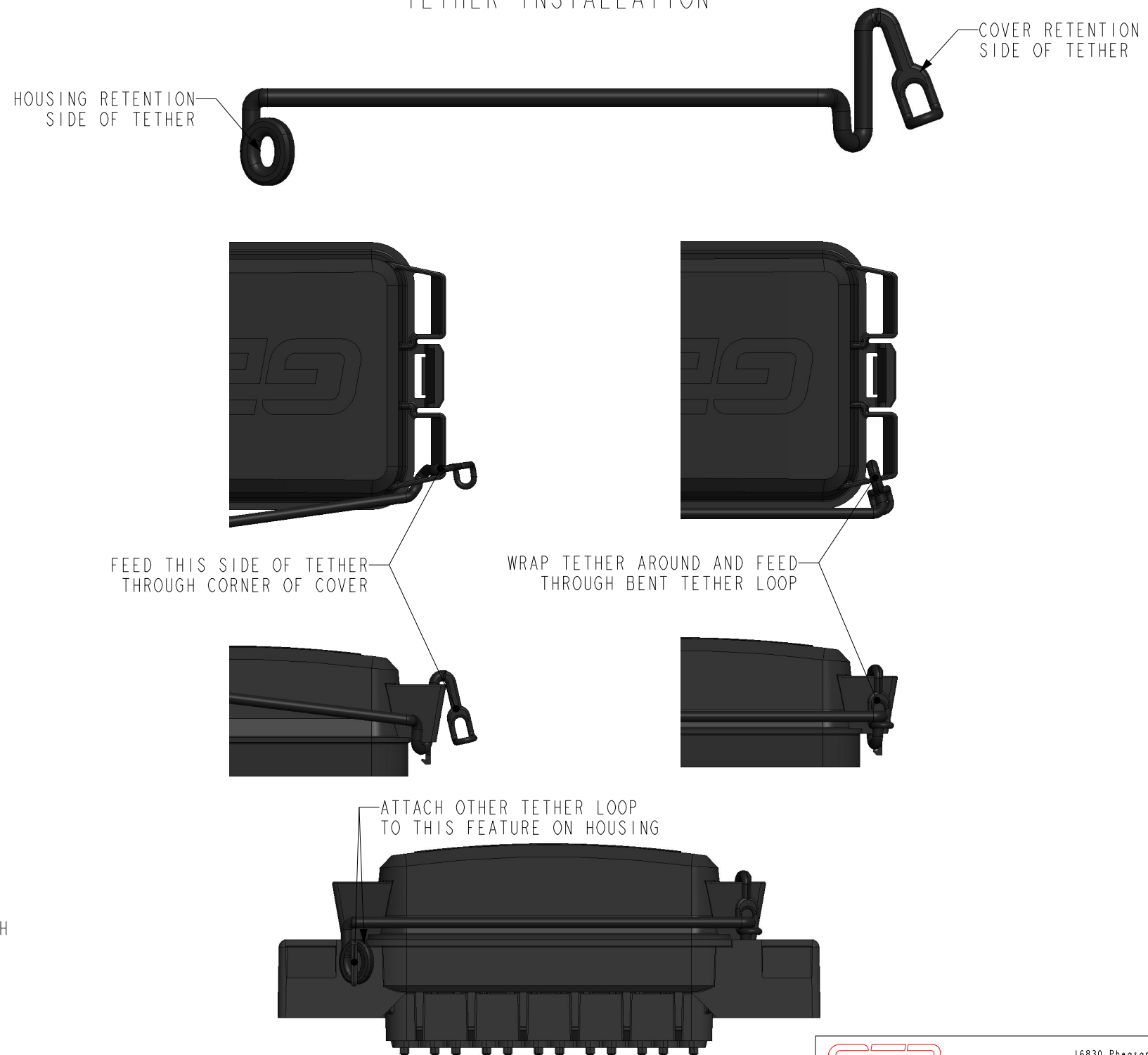

		16830 Pheasant Drive Brookfield, WI 53005		
PART NO:	PDM-U SERIES (SALES)			
DESCRIPTION:	POWER DISTRIBUTION MODULE - MODEL U, SERIES DRAWING			
CUSTOMER:	STANDARD			
METRIC (MM)	REV 3	SHEET 8 OF 9	SCALE 1:1.667	SIZE B

DEPINNING INSTRUCTIONS

280 TERMINAL DEPINNING

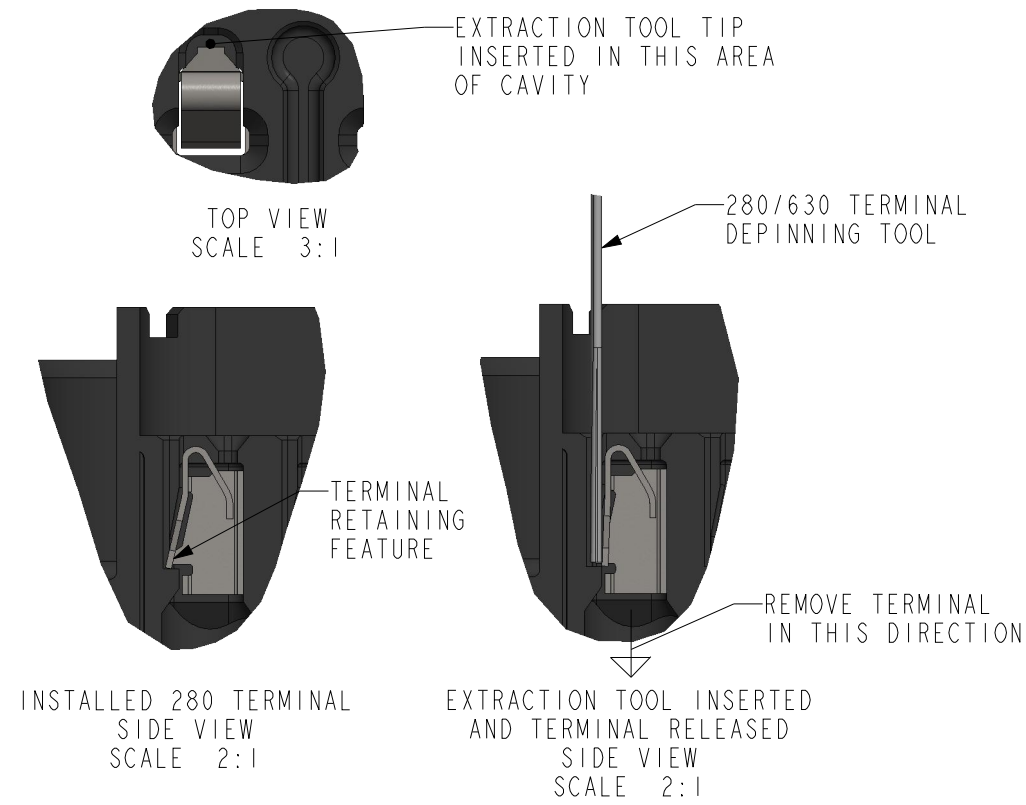

630 TERMINAL DEPINNING

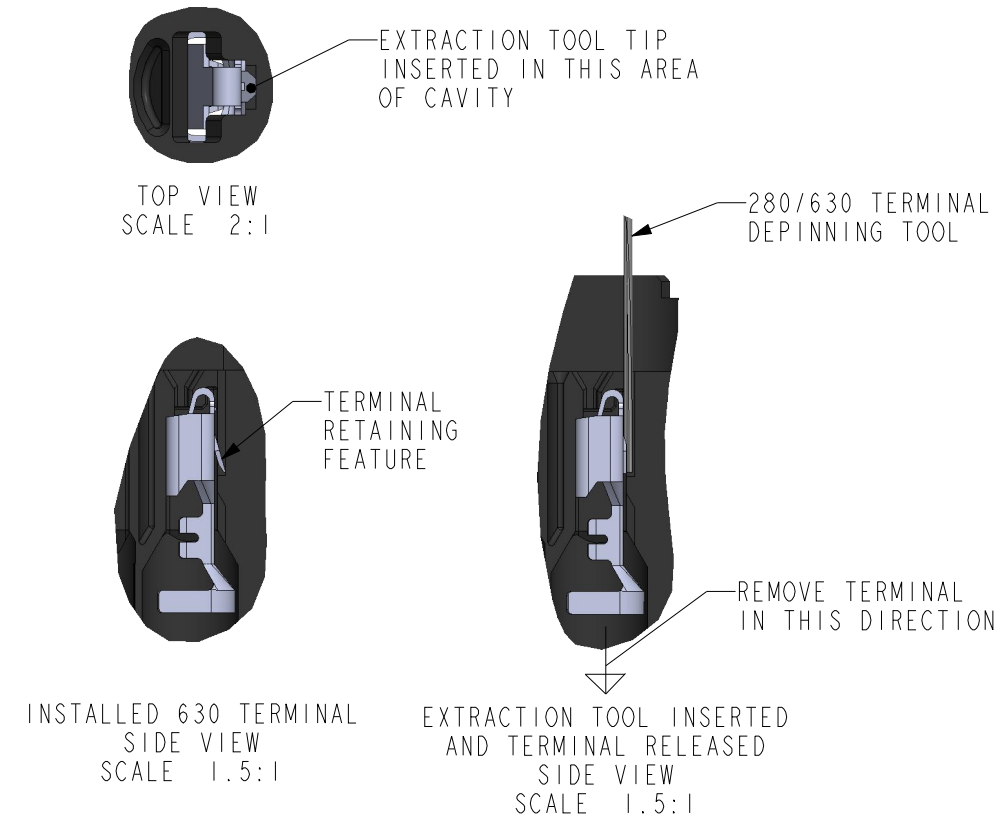

GEP POWER PRODUCTS		16830 Pheasant Drive Brookfield, WI 53005		
PART NO:		PDM-U SERIES (SALES)		
DESCRIPTION:		POWER DISTRIBUTION MODULE - MODEL U, SERIES DRAWING		
CUSTOMER:		STANDARD		
METRIC (MM)	REV	SHEET	SCALE	SIZE
	3	9 OF 9	1:1	B