

REV	REVISION DETAILS	ECO	DATE	BY	ABY
0	RELEASE FOR PRODUCTION	13187	04-14-2017	RRR	JML
1	UPDATED FORMAT. ADDED VIEWS, DIMENSIONS.	NP-000822	01-31-2018	JWK	JML
2	UPDATED TO LATEST DRAWING STANDARDS ADDED PART NUMBERS SC19-2001A-A001, SC56-2000A-B001, SC55-2000A-A001. UPDATED PART NUMBER AND DESCRIPTION.	NP-006047	03-27-2024	JWK	JML
3	UPDATED NOTES	NP-006108	04-26-2024	JWK	JML

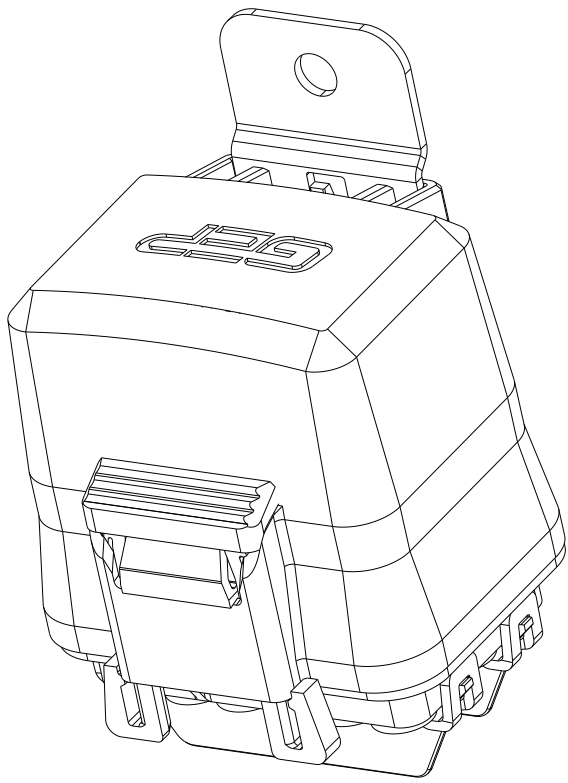

ISO VIEW
FOR REF ONLY

CONFIDENTIAL

The information contained in this document is the property of GEP Power Products. It is not for public disclosure. Possession of the information does not convey any right to loan, sell or disclose the information. Unauthorized reproduction or use of the information is prohibited. This document is to be returned to GEP Power Products upon completion of the purpose for which it is loaned or upon request.

CRITICAL DIMENSIONS ON FEATURES TO BE CHECKED DURING ANY SET-UP ADJUSTMENTS, TOOL CHANGES, OR ANNUAL MAINTENANCE ON TOOLING.	DIMENSIONS OR FEATURES TO BE CHECKED FROM RUN-TO-RUN
TOLERANCES UNLESS OTHERWISE SPECIFIED	
THIRD ANGLE PROJECTION 	
METRIC TOL	ENGLISH TOL
1 PL DEC. = ±.25 2 PL DEC. = ±.13	2 PL DEC. = ±.01 3 PL DEC. = ±.005
ANGULAR TOL = ±2° FRACTION TOL = ±1/64 IN	
DIMENSIONS INSIDE PARENTHESES OR CONTAINING "REF" ARE FOR REFERENCE ONLY.	

COPYRIGHT - GEP POWER PRODUCTS

This is unpublished work. The disclosure of this work is limited to a select personnel. Further dissemination or disclosure to the public is PROHIBITED. This unpublished work is protected by Federal Copyright law and all rights thereunder are reserved by GEP Power Products.

		16830 Pheasant Drive Brookfield, WI 53005	
PART NO:		FRH-A24 PDM SERIES (SALES)	
DESCRIPTION:		FRH-A24 PDM SERIES (SALES)	
CUSTOMER:		STANDARD	
METRIC (MM)	REV	SHEET	SCALE
	3	1 OF 8	1:1
			SIZE B

EXAMPLE CONFIGURATION & NOTES

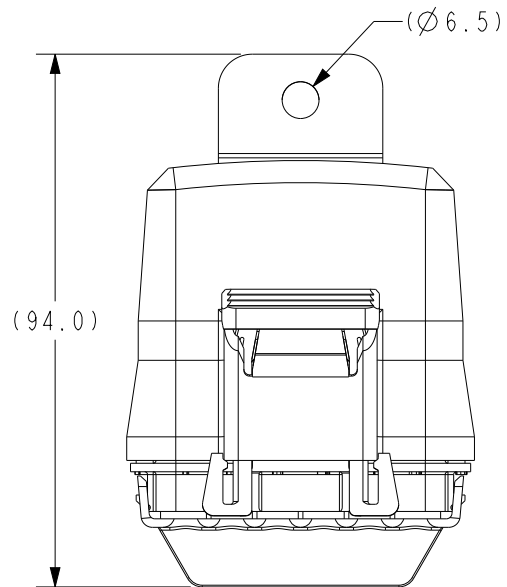
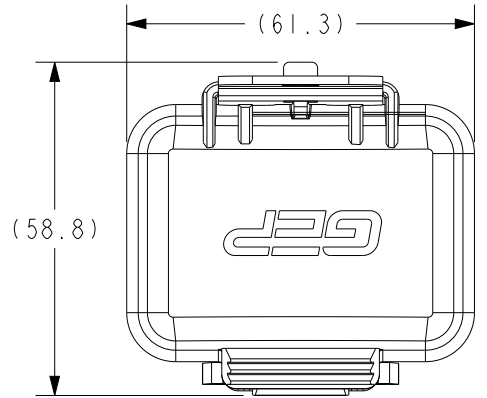

EXAMPLE CONFIGURATION WITH DIMENSIONAL INFO

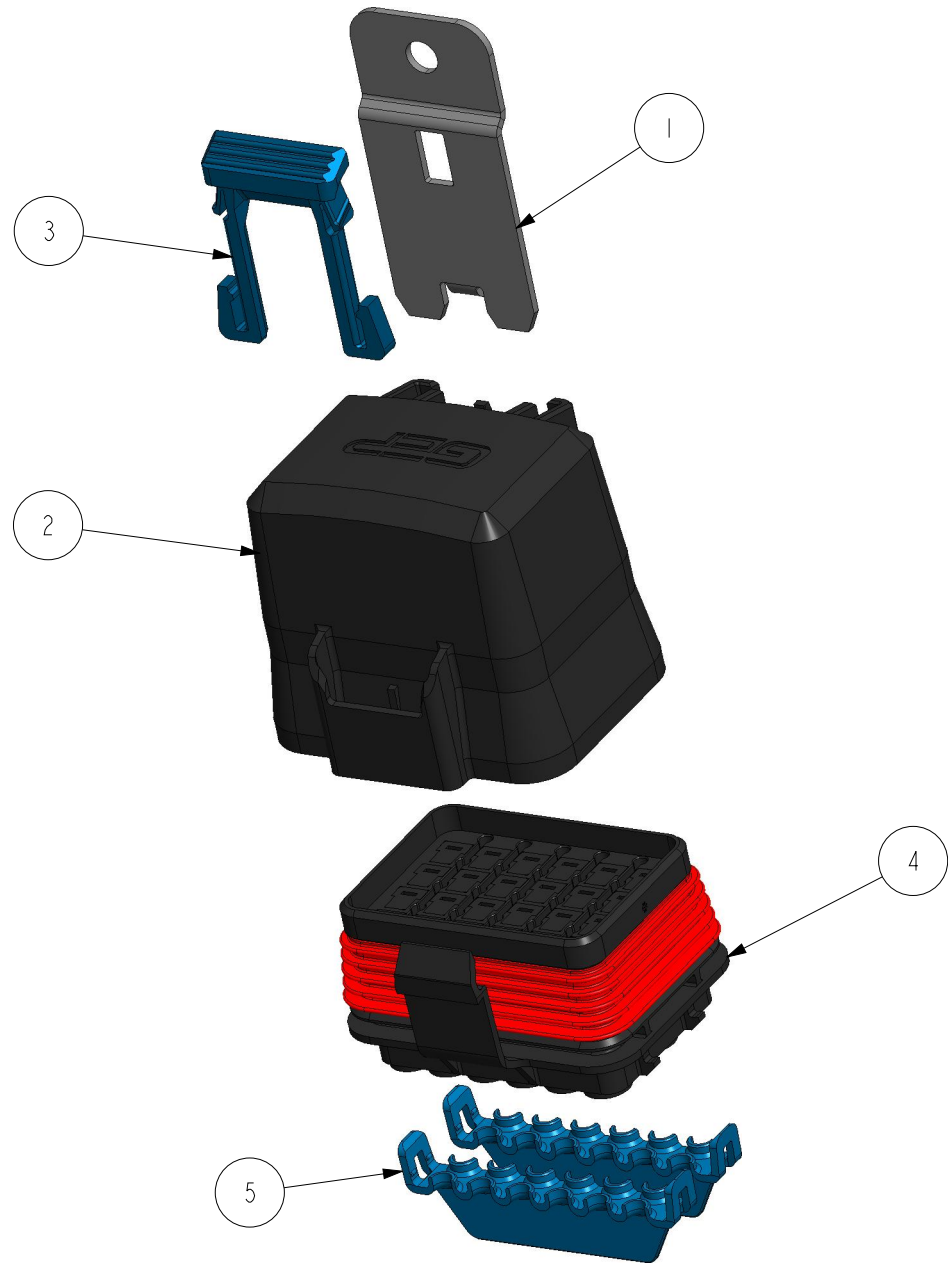

EXAMPLE CONFIGURATION EXPLODE VIEW

- NOTES:
- 1. BASE, COVER, & CPA MATERIAL: UNFILLED PBT
 - 2. TPA & DIODE KEY MATERIAL: NYLON
 - 3. BRACKET MATERIAL: ZINC PLATED STEEL OR STAINLESS STEEL (SEE PART DESCRIPTION)
 - 4. DESIGNED TO USE DELPHI 280 METRI-PACK TERMINALS AND SEALS (SEE TABLE A)
 - 5. RoHS AND REACH COMPLIANT

EXAMPLE CONFIGURATION BOM			
ITEM	DESCRIPTION	PART NO.	QTY
1	BRACKET - PDM, FRH, FLAT WITH ANTI-ROTATION, ZINC STEEL	FRH-A12-MB-A1	1
2	COVER - PDM, FRH 24 POS	FRH-A24-C	1
3	CPA - PDM, FRH	FRH-A-CPA	1
4	HOUSING AND SEAL - PDM, FRH 24 POS	FRH-A24	1
5	TPA - PDM, FRH	FRH-A12-T	2

		16830 Pheasant Drive Brookfield, WI 53005		
PART NO:		FRH-A24 PDM SERIES (SALES)		
DESCRIPTION:		FRH-A24 PDM SERIES (SALES)		
CUSTOMER:		STANDARD		
METRIC (MM)	REV	SHEET	SCALE	SIZE
	3	2 OF 8	1:1.333	B

HOUSING W/SEAL OPTIONS

FRH-A24
 HOUSING AND SEAL - PDM, FRH 24 POS
 (FOR TERMINALS AND SEALS
 SEE TABLE A)

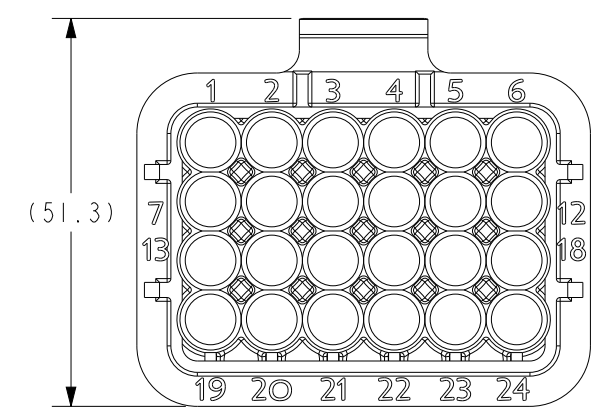
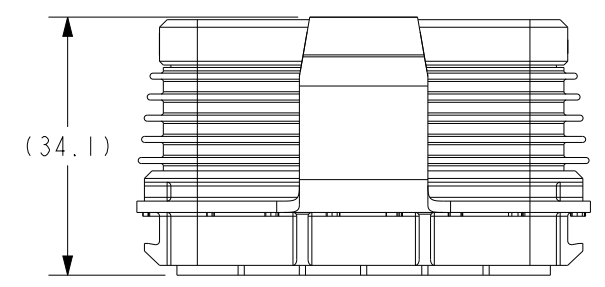
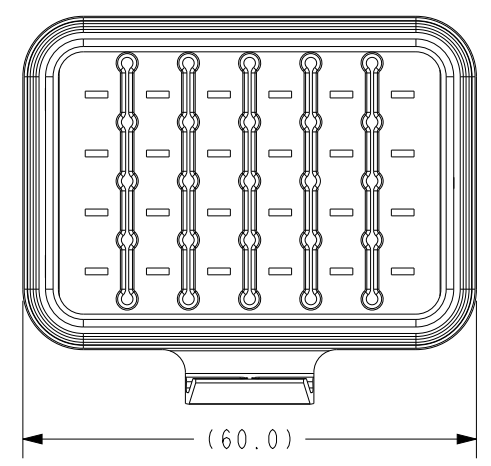

GEP POWER PRODUCTS		16830 Pheasant Drive Brookfield, WI 53005		
PART NO:		FRH-A24 PDM SERIES (SALES)		
DESCRIPTION:		FRH-A24 PDM SERIES (SALES)		
CUSTOMER:		STANDARD		
METRIC (MM)	REV	SHEET	SCALE	SIZE
	3	3 OF 8	1:1.5	B

HOUSING TERMINALS AND SEALS

FRH-A24
HOUSING AND SEAL - PDM, FRH 24 POS

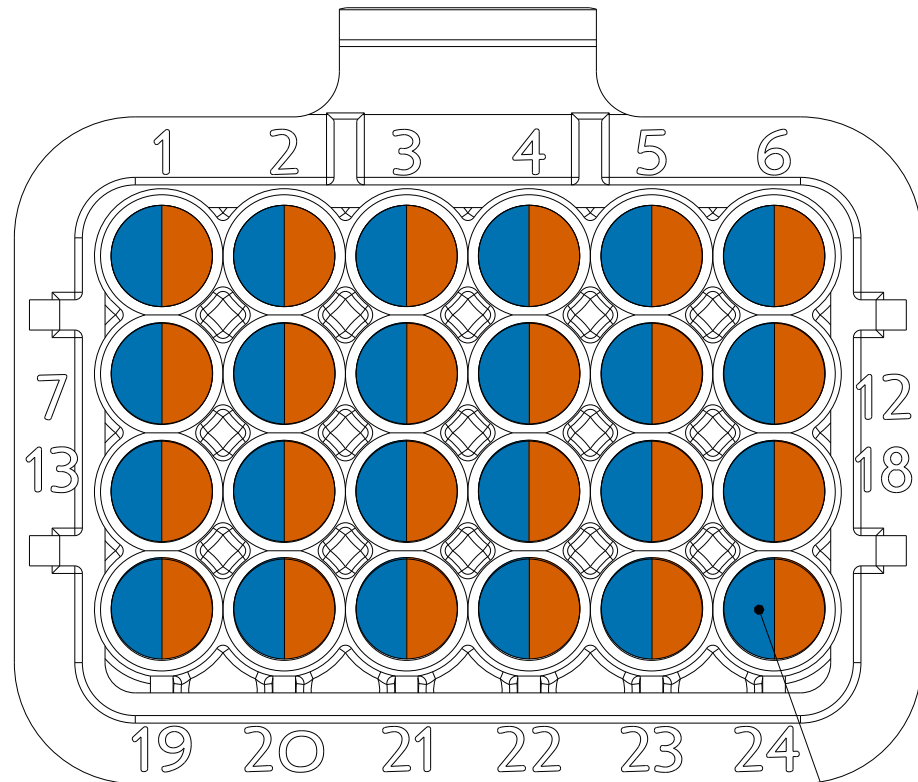

280 CAVITIES
SEE TABLE A FOR TERMINALS
AND CABLE SEALS

Table A

DELPHI 280 METRI-PACK TERMINALS				
PART #	CABLE RANGE (mm ²)	MATERIAL	PLATING	
12077413	3	TIN BRASS	TIN	
12129493	2.0-3.0	TIN BRASS	TIN	
12077411	0.8-1.0	TIN BRASS	TIN	
12084201	0.35-0.50	TIN BRASS	TIN	
12176387	5	BERYLLIUM COPPER	SILVER/NICKEL	
12176388	2.0-3.0	BERYLLIUM COPPER	SILVER/NICKEL	
12176389	0.8-1.0	BERYLLIUM COPPER	SILVER/NICKEL	
DELPHI 280 METRI-PACK CABLE SEALS (FOR REF. ONLY)				
PART # REEL	PART # LOOSE	CABLE DIA.	MATERIAL	COLOR
12015360	12015193	3.45-4.3	SILICONE	BLUE
12015359	12010293	2.81-3.49	SILICONE	LT. GRAY
12015284	12015323	2.03-2.85	SILICONE	GREEN
12041352	12041351	2.03-2.42	SILICONE	TAN
12089444	12089679	1.6-2.15	SILICONE	PURPLE
12034365	12015899	1.29-1.70	SILICONE	DK. RED
	12010300	PLUG	SILICONE	GREEN
DELPHI 280 METRI-PACK TERMINAL REMOVAL TOOL (FOR REF. ONLY)				
PART # 12094430				

		16830 Pheasant Drive Brookfield, WI 53005		
PART NO:		FRH-A24 PDM SERIES (SALES)		
DESCRIPTION:		FRH-A24 PDM SERIES (SALES)		
CUSTOMER:		STANDARD		
METRIC (MM)	REV	SHEET	SCALE	SIZE
	3	4 OF 8	1:1.333	B

COVER OPTIONS

FRH-A24-C
COVER - PDM, FRH 24 POS

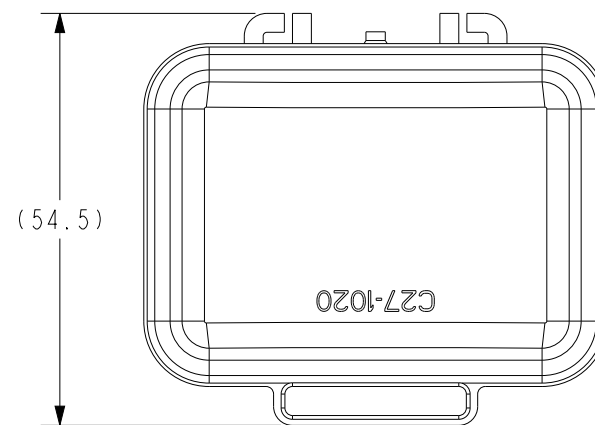
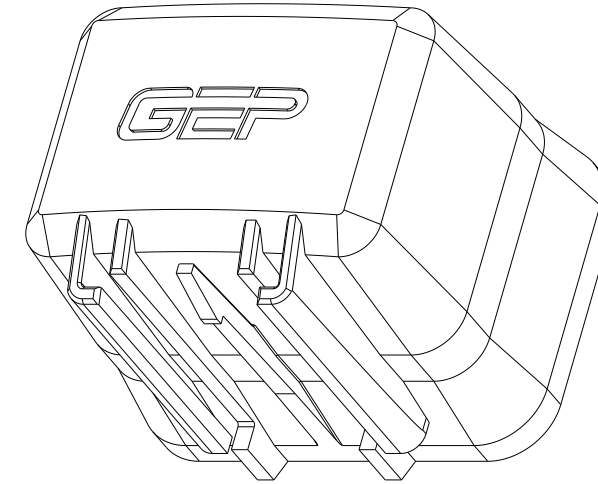
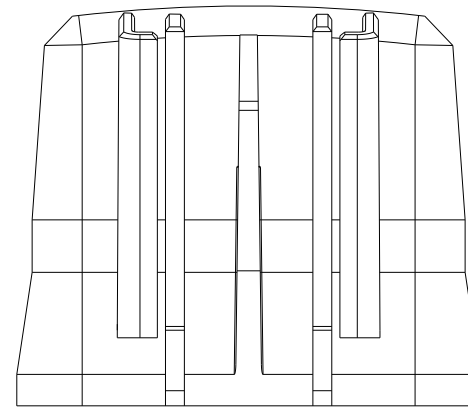
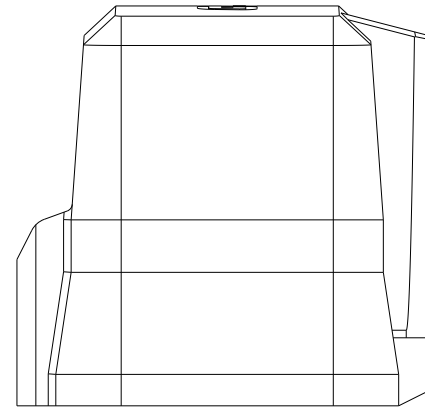

		16830 Pheasant Drive Brookfield, WI 53005		
PART NO:		FRH-A24 PDM SERIES (SALES)		
DESCRIPTION:		FRH-A24 PDM SERIES (SALES)		
CUSTOMER:		STANDARD		
METRIC (MM)	REV	SHEET	SCALE	SIZE
	3	5 OF 8	1:1.333	B

FRH - ACCESSORY OPTIONS

FOR NON-STANDARD MOUNTING OPTIONS EMAIL
GEPENGINEERING@GEPPOWERPRODUCTS.COM TO REVIEW

FRH-A12-MB-A1
BRACKET - PDM,FRH,FLAT WITH ANTI-ROTATION, ZINC STEEL

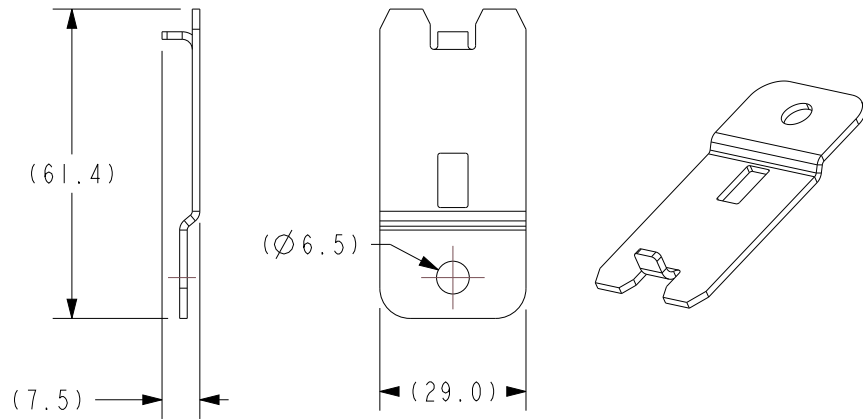

FRH-A12-MB-A2
BRACKET - PDM, FRH, FLAT WITH ANTI-ROTATION, STAINLESS 304

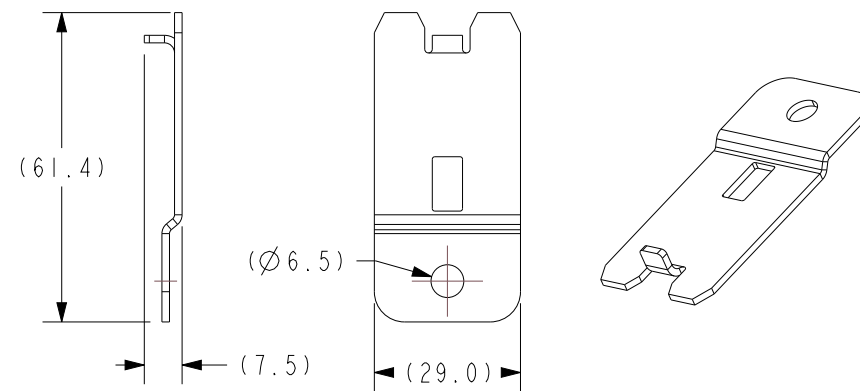

FRH-A12-MB-B1
BRACKET - PDM, FRH, FLAT WITHOUT ANTI-ROTATION, ZINC STEEL

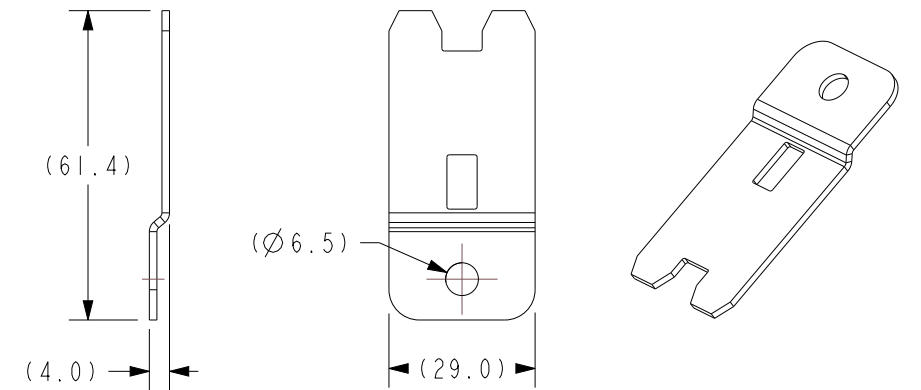

FRH-A12-MB-B2
BRACKET - PDM, FRH, FLAT WITHOUT ANTI-ROTATION, STAINLESS 304

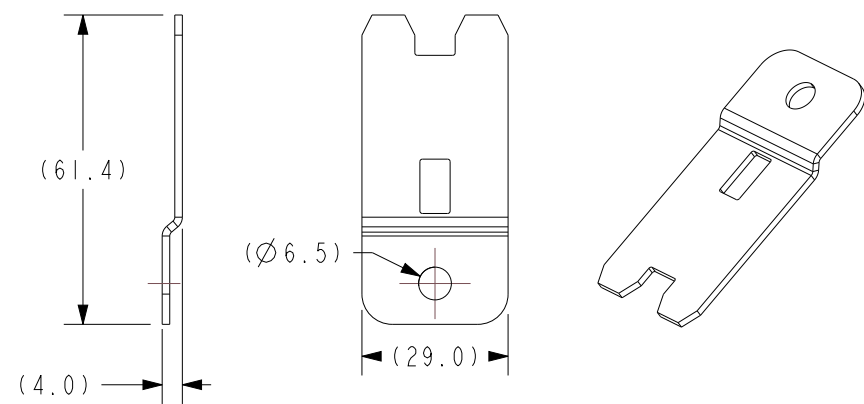

FRH-A12-MB-C1
BRACKET - PDM, FRH, 90° BENT, ZINC STEEL

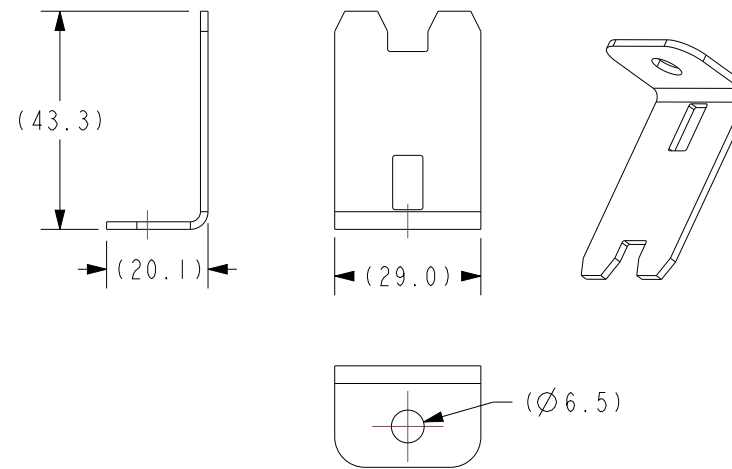

FRH-A12-MB-C2
BRACKET - PDM, FRH, 90° BENT, STAINLESS 304

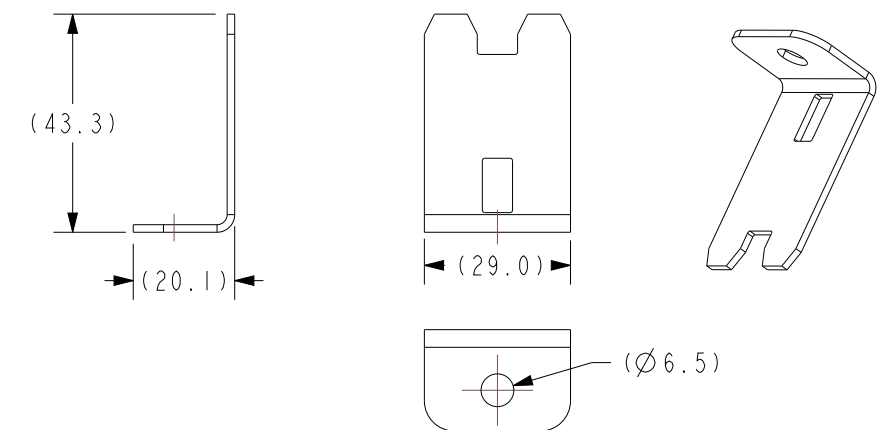

FRH-A-CPA
CPA - PDM, FRH

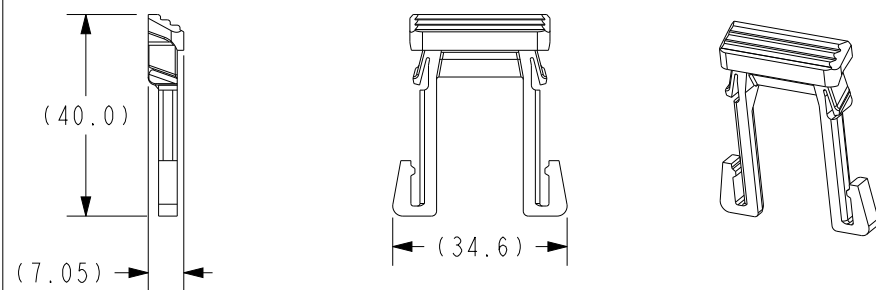

FRH-A12-T
TPA - PDM, FRH

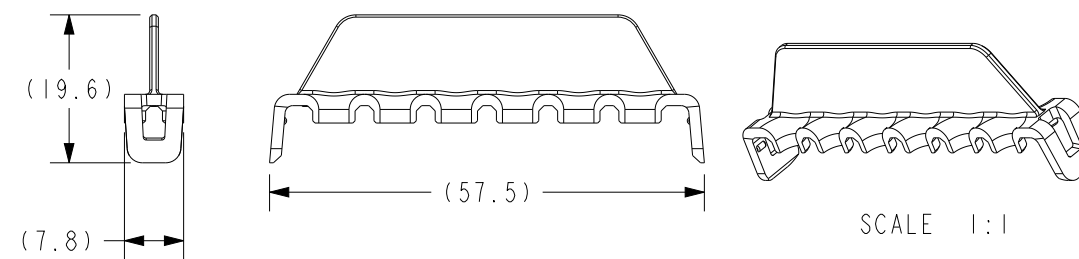

PDM-TK
DIODE KEY

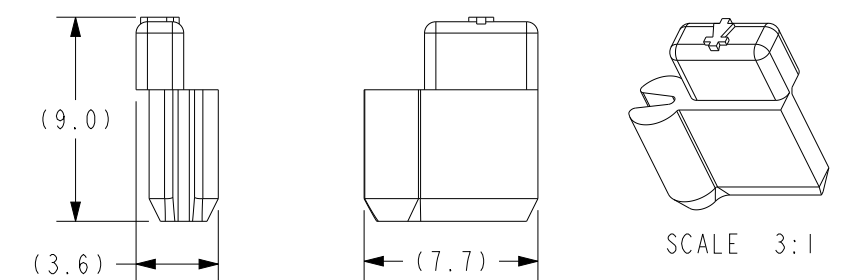

GEP POWER PRODUCTS		16830 Pheasant Drive Brookfield, WI 53005		
PART NO:	FRH-A24 PDM SERIES (SALES)			
DESCRIPTION:	FRH-A24 PDM SERIES (SALES)			
CUSTOMER:	STANDARD			
METRIC (MM)	REV 3	SHEET 6 OF 8	SCALE 1:1.5	SIZE B

ACCESSORY ASSEMBLY INSTRUCTIONS

CPA INSTALLATION

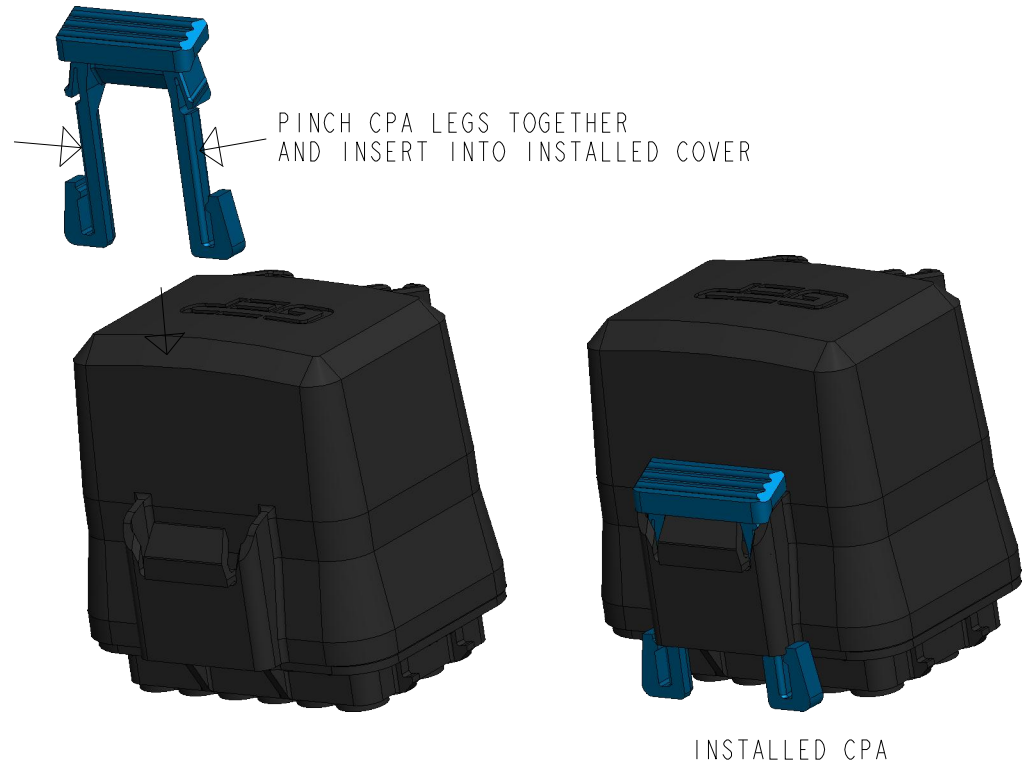

MOUNTING BRACKET INSTALLATION

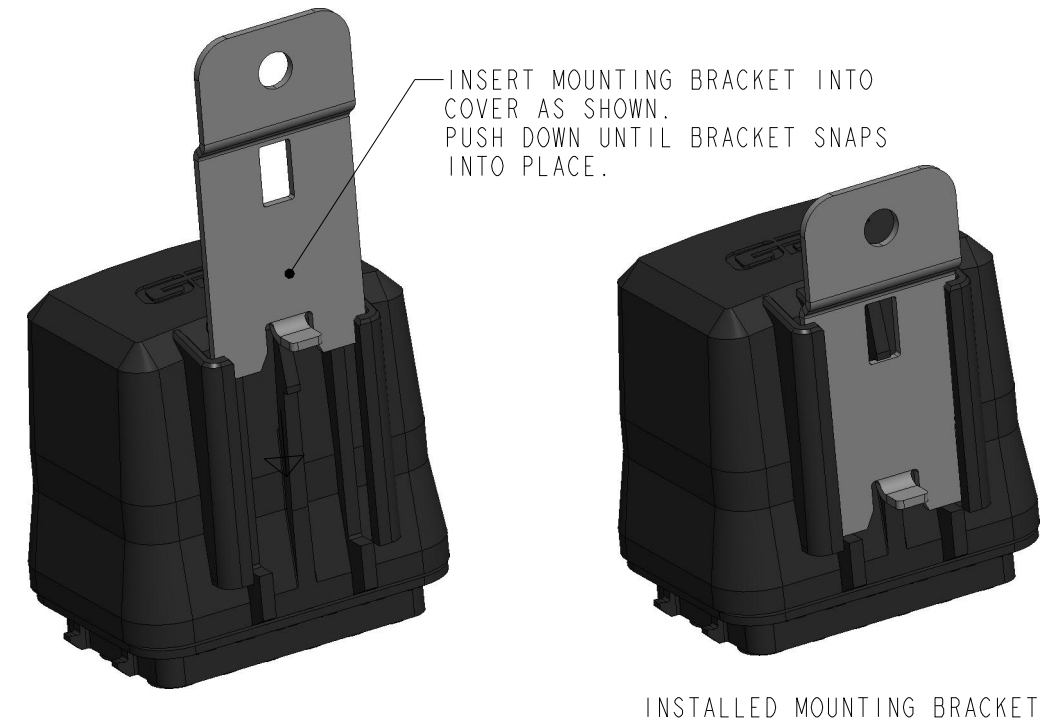

TPA INSTALLATION

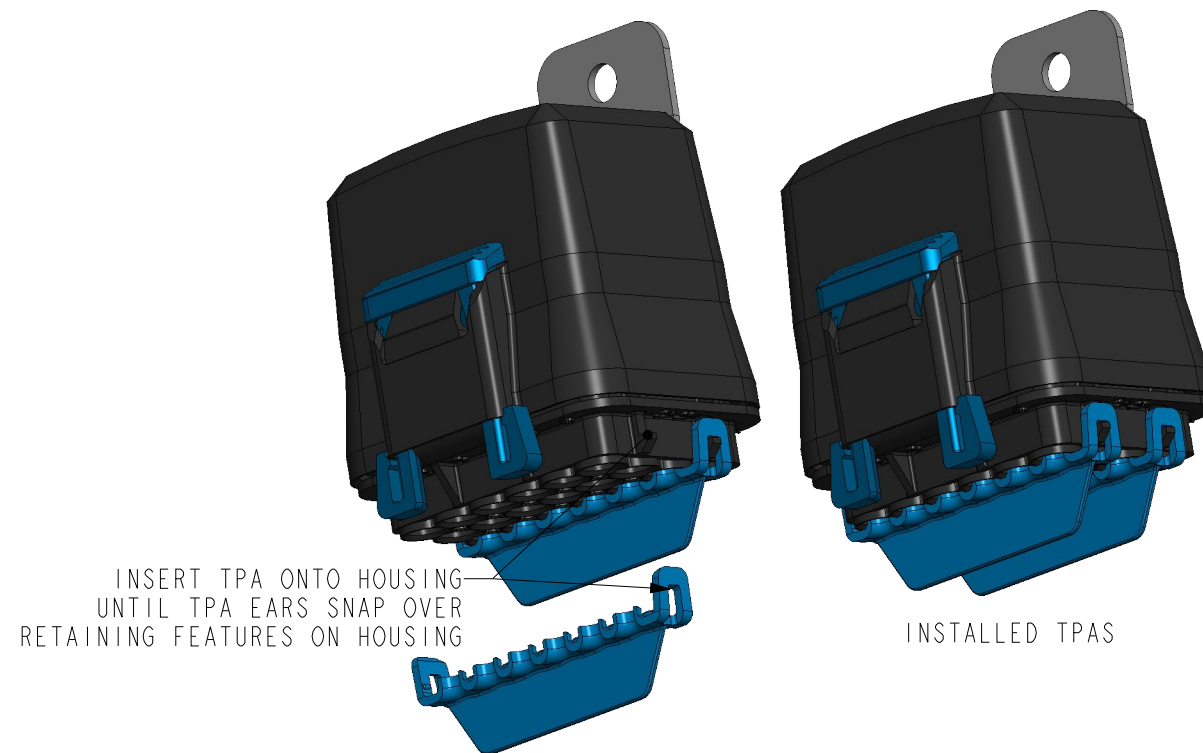

GEP POWER PRODUCTS		16830 Pheasant Drive Brookfield, WI 53005		
PART NO:	FRH-A24 PDM SERIES (SALES)			
DESCRIPTION:	FRH-A24 PDM SERIES (SALES)			
CUSTOMER:	STANDARD			
METRIC (MM)	REV 3	SHEET 7 OF 8	SCALE 1:1.25	SIZE B

DEPINNING INSTRUCTIONS

280 TERMINAL DEPINNING

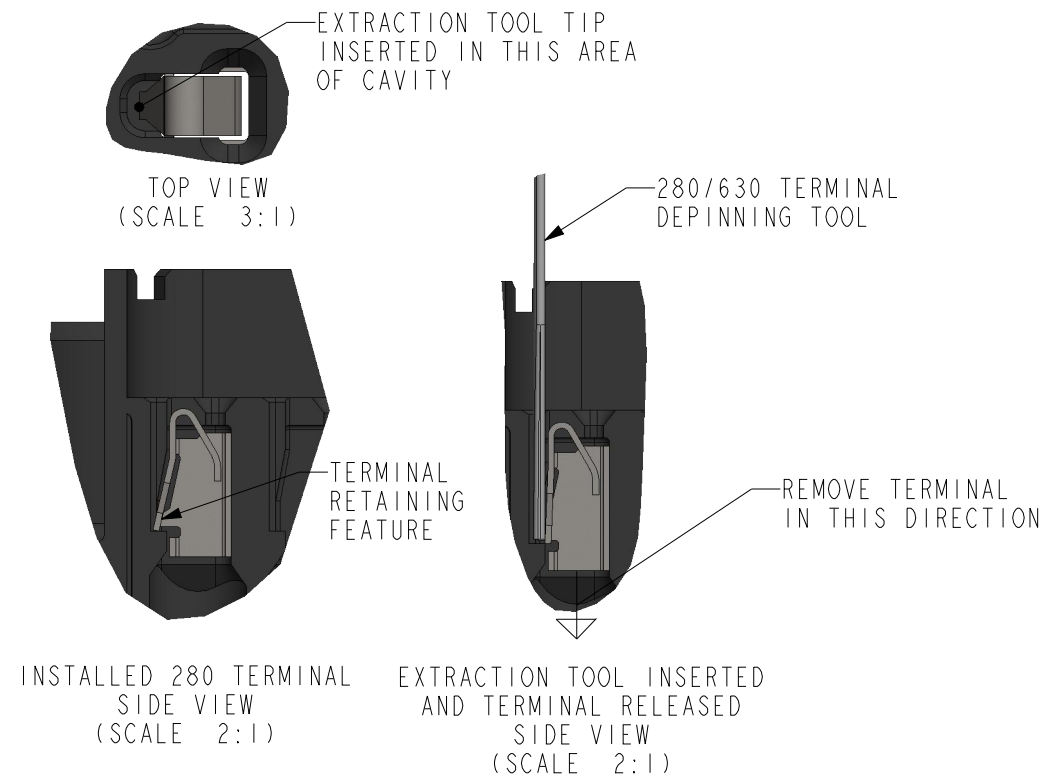

		16830 Pheasant Drive Brookfield, WI 53005		
PART NO:		FRH-A24 PDM SERIES (SALES)		
DESCRIPTION:		FRH-A24 PDM SERIES (SALES)		
CUSTOMER:		STANDARD		
METRIC (MM)	REV	SHEET	SCALE	SIZE
	3	8 OF 8	1:1	B